

Stamped eye

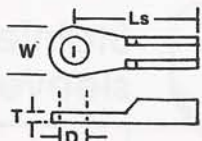

Stainless steel or zinc plated carbon steel
other sizes available.

Cable Size	Ls	W	D	T
1/16"	1.00	.42	.19	.062
1/16	1.00	.42	.260	.062
3/32	1.40	.500	.205 & .250	.093
3/32	1.30	.750	.375 & .500	.093
1/8	1.95	.580	.250 & .315	.125
1/8	1.85	.850	.375 & .500	.125

Plain ball

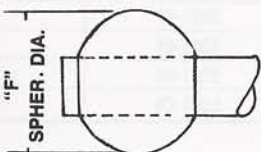
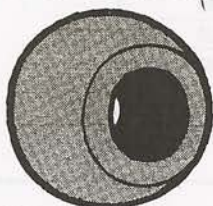

NOTE: Ultimate breaking strength sizes 3/32" and smaller—80% of Catalog Nominal Strength. Sizes 1/8" and larger—60% of Catalog Nominal Strength (applies to 7 x 7 and 7 x 19 rope [cable] construction only).

DASH NUMBER	ROPE DIAMETER	SPHER. DIAMETER
-1	1/32"	.188
-2	1/16	.188
-3	3/32	.250
-4	1/8	.315
-5	5/32	.375
-6	3/16	.438
-7	7/32	.500
-8	1/4	.563
-10	5/16	.688

Ball and shank

MS20664C

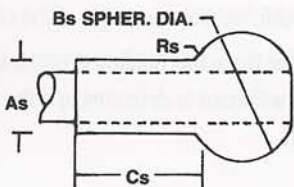
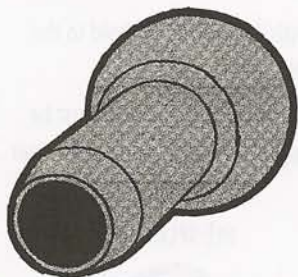

DASH NO.	NOM. ROPE DIA.	NOM. INAL STR. (LBS.)	As DIAMETER	Bs DIAMETER	Cs REF.	Rs MAX. RAD.
-2	1/16"	480	.112	.190	.156	.014
-3	3/32	920	.143	.253	.234	.019
-4	1/8	2000	.190	.315	.313	.023
-5	5/32	2800	.222	.379	.391	.028
-6	3/16	4200	.255	.442	.469	.033
-7	7/32	5600	.302	.505	.547	.038
-8	1/4	7000	.348	.567	.625	.042
-10	5/16	9800	.413	.694	.813	.046

Ball and double shank

MS20663C

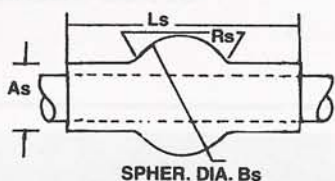
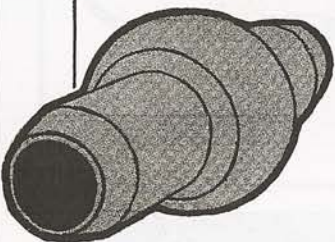

DASH NO.	NOM. ROPE DIA.	NOM. INAL STR. (LBS.)	As DIAMETER	Bs DIAMETER	Ls REF.	Rs MAX. RAD.
-2	1/16"	480	.112	.190	.390	.014
-3	3/32	920	.143	.253	.578	.019
-4	1/8	2000	.190	.315	.765	.023
-5	5/32	2800	.222	.379	.953	.028
-6	3/16	4200	.255	.442	1.140	.033
-8	1/4	7000	.348	.567	1.515	.042

Straps



Fork end
NAS 1435-K

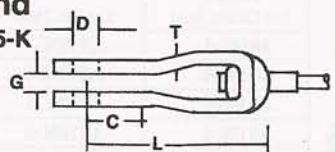

Eye end
NAS 1435-E

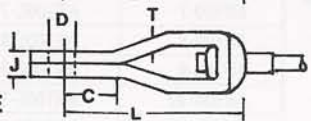

EYE AND FORK	WIRE ROPE DIAMETER	L	C	D	T	FORK G	EYE J
-2	1/16"	1-1/16	.454	.188	.042	.093	.088
-3	3/32	1-1/2	.616	.188	.049	.108	.103
-4	1/8	1-5/8	.638	.188	.093	.195	.190
-5	5/32	1-15/16	.699	.250	.096	.202	.197
-6	3/16	2-3/16	.750	.313	.125	.260	.255