

## CRESCENT THIMBLE

CRESCENT THIMBLES are designed to protect the bearing surface of a loop where a large dimension loop is necessary. The ears are tapered so that they can be bent or peaned over wire rope. Standard-Laid Rope Size 3/8" to 3".

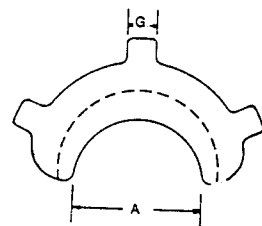

### DIMENSIONS & DATA

NEWCO NUMBER	ROPE SIZE SINGLE	8PTS. BRAID ROPE DIA.	6PTS. BRAID ROPE DIA.	A	B	C	D	E	F	G	H	APPROX. WT. LBS.
6C	3/8-7/16	3/32-1/8	1/8	2	1	27/32	15/32	2 1/16	3/8	1/2	3/8	.50
8C	1/2-9/16	3/16	3/16	2 1/4	1 1/8	1	5/8	2 1/2	1/2	1/2	1/2	.75
9C	5/8		1/4	2 3/4	1 3/8	1 5/32	23/32	3	19/32	9/16	19/32	1.2
10C	3/4	1/4	5/16	3 1/4	1 5/8	1 5/16	13/16	3 1/2	5/8	5/8	5/8	2.0
14C	7/8			4 1/2	2 1/4	1 7/16	15/16	4 5/16	3/4	11/16	3/4	3.3
16C	1	5/16	3/8	4 1/2	2 1/4	1 9/16	1 1/16	4 19/32	13/16	3/4	7/8	3.75
18C	1 1/8	3/8	7/16	4 7/8	2 7/16	1 13/16	1 1/4	5 1/32	7/8	7/8	1	5.0
20C	1 1/4	7/16	1/2	5 1/2	2 3/4	2 1/16	1 7/16	5 3/4	15/16	15/16	1 1/8	6.75
22C	1 3/8-1 1/2	1/2	9/16	6	3	2 1/4	1 5/8	6 1/4	1 1/16	1 1/8	1 3/16	9.0
24C	1 5/8	9/16	5/8	6 1/2	3 1/4	2 1/2	1 3/4	6 11/16	1 1/8	1 1/4	1 1/4	12.0
28C	1 3/4-1 7/8			7	3 1/2	2 15/16	1 15/16	7 3/8	1 1/4	1 3/8	1 1/2	16.6
32C	2	5/8	3/4	7	3 1/2	3 3/16	2 3/16	7 13/16	1 1/2	1 1/2	1 5/8	21.8
40C	2 1/4-2 1/2	3/4-7/8	1	8 1/2	4 1/4	4 1/8	2 7/8	9 5/8	1 5/8	1 7/8	2	39.0
48C	2 3/4-3	1	1 1/8	10	5	4 7/8	3 3/8	11 1/4	1 3/4	2 1/4	2 1/2	67.0

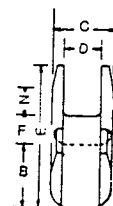

## EQUALIZING THIMBLE

### SINGLE AND DOUBLE GROOVE

Provides for the adjustment of the length of the legs of bridle slings so as to lift unbalanced loads evenly. Makes all bridle slings more versatile while eliminating center ring and two splices. — Material: Cast Electric Steel.

NOTE: DG - DESIGNATES DOUBLE GROOVE EQUALIZING THIMBLE

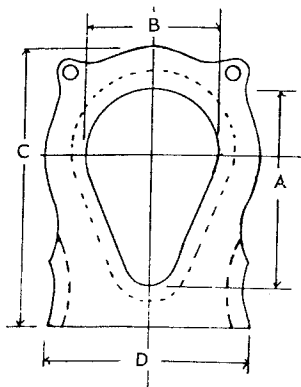

### DIMENSIONS & DATA

PART NO.	SIZE ROPE DIA.	A	B	C	D	E	F	WT. LBS.
3E	3/8-7/16	4 1/2	3	6 7/16	4 5/8	7/8	1/2	3.0
4E	1/2-9/16	6	4	8 1/2	6 3/16	1 1/8	5/8	6.3
5E	5/8-3/4	7	4 1/2	9 15/16	7	1 7/16	15/16	11
8E	7/8-1	7 1/8	5	10 3/4	8 3/4	1 13/16	1 3/16	15.6
10E	1 1/8-1 1/4	10	6 1/2	14 3/8	10 7/8	2 3/16	1 7/16	28
12E	1 3/8-1 1/2	11	7 1/2	15 7/8	11 3/4	2 9/16	1 11/16	39
4E	1 5/8-1 3/4	15	9	20 13/16	14 1/4	2 15/16	1 15/16	71
16E	1 7/8-2	15	9	21 5/8	14 7/8	3 5/16	2 3/16	85
*DG6E	5/8-3/4	8 1/4	5 1/2	11 1/4	8	2 3/8	1 3/4	21
*DG8E	7/8-1	9	6	12 3/4	8 1/2	2 7/8	2 1/4	28
*DG10E	1 1/8-1 1/4	11 1/2	7 1/2	16	12 1/8	3 1/4	2 5/8	45

