

STUD LINK ANCHOR CHAIN

MIL-C-24633A
US NAVY
DOD

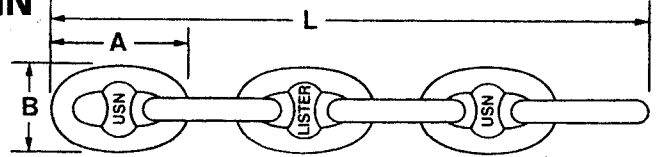

Stud link chain dimensions and properties

Chain size inches	Link length A inches	L Length over 6 links inches			Link width B inches	Number of links per 15-fathom shot	Proof test load (lb)	Break test load (lb)	Nominal weight per 15-fathom shot (lb)*
		Minimum	Nominal	Maximum					
3/4	4 1/2	19 3/8	19 1/2	19 13/16	2 5/8	359	48,000	75,000	480
7/8	5 1/4	22 5/8	22 3/4	23 1/16	3 1/8	305	64,400	98,000	660
1	6	25 7/8	26	26 3/8	3 9/16	267	84,000	129,000	860
1 1/8	6 3/4	29 1/16	29 1/4	29 5/8	4	237	106,000	161,000	1,080
1 1/4	7 1/2	32 5/16	32 1/2	32 15/16	4 1/2	213	130,000	198,000	1,350
1 3/8	8 1/4	35 9/16	35 3/4	36 1/4	4 15/16	193	157,000	235,000	1,630
1 1/2	9	38 13/16	39	39 1/2	5 3/8	177	185,000	280,000	1,940
1 5/8	9 3/4	42	42 1/4	42 7/8	5 7/8	165	216,000	325,000	2,240
1 3/4	10 1/2	45 1/4	45 1/2	46 1/8	6 5/16	153	249,000	380,000	2,590
1 7/8	11 1/4	48 1/2	48 3/4	49 1/2	6 3/4	143	285,000	432,000	2,980
2	12	51 11/16	52	52 3/4	7 3/16	135	318,000	454,000	3,360
2 1/8	12 3/4	54 15/16	55 1/4	56 1/8	7 5/8	125	357,000	510,000	3,790
2 1/4	13 1/2	58 3/16	58 1/2	59 3/8	8 1/8	119	396,000	570,000	4,250
2 3/8	14 1/4	61 7/16	61 3/4	62 3/4	8 9/16	113	440,000	628,000	4,730
2 1/2	15	64 11/16	65	66	9	107	484,000	692,000	5,270
2 5/8	15 3/4	67 7/8	68 1/4	69 1/4	9 7/16	101	530,000	758,000	5,820
2 3/4	16 1/2	71 1/8	71 1/2	72 9/16	9 7/8	97	578,000	826,000	6,410
2 7/8	17 1/4	74 3/8	74 3/4	75 7/8	10 3/8	93	628,000	897,000	7,020
3	18	77 5/8	78	79 9/16	10 13/16	89	679,000	970,000	7,650
3 1/8	18 3/4	80 13/16	81 1/4	82 1/2	11 1/4	87	732,000	1,046,000	8,320
3 1/4	19 1/2	84 1/16	84 1/2	85 3/4	11 11/16	83	787,000	1,124,000	9,010
3 3/8	20 1/4	87 5/16	87 3/4	89	12 1/8	79	843,000	1,204,000	9,730
3 1/2	21	90 9/16	91	92 5/16	12 5/8	77	900,000	1,285,000	10,500
3 5/8	21 3/4	93 13/16	94 1/4	95 5/8	12 15/16	73	958,000	1,369,000	11,300
3 3/4	22 1/2	97 1/16	97 1/2	98 7/8	13 3/8	71	1,019,000	1,455,000	12,000
3 7/8	23 1/4	100 1/4	100 3/4	102 3/16	14	69	1,080,000	1,543,000	12,900
4	24	103 1/2	104	105 1/2	14 3/8	67	1,143,000	1,632,000	13,700
4 3/4	28 1/2	122 15/16	123 1/2	125 5/16	17 1/8	57	1,700,000	2,550,000	18,900

SWIVEL

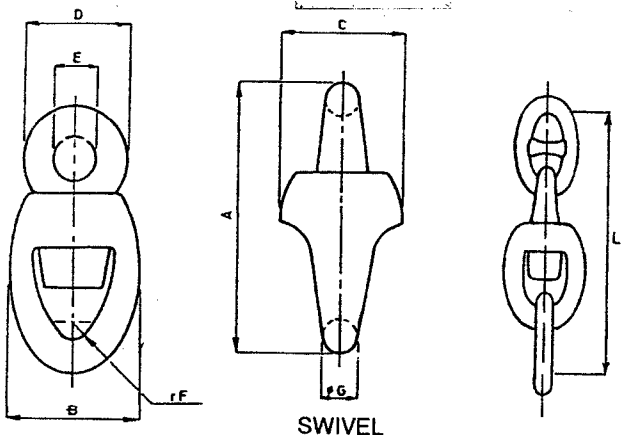

SWIVEL

CHAIN SIZE		Weight		Proof Test KGF	Break Test KGF
mm	inches	kg	lbs.		
30-35	1-3/16 - 1-3/8	21.0	46.3	70700	101300
36-42	1-7/16 - 1-5/8	39.5	87.1	102000	143400
43-48	1-11/16 - 1-7/8	66.0	145.5	130000	185100
49-58	1-15/16 - 2-1/4	104.0	229.3	185400	265000
59-67	2-5/16 - 2-5/8	142.0	313.1	242900	347000
68-73	2-11/16 - 2-7/8	208.0	458.6	285000	407000
75-79	2-15/16 - 3-1/8	276.0	608.5	332100	474500
81-86	3-3/16 - 3-3/8	336.0	740.8	384400	549100
87-92	3-7/16 - 3-5/8	376.0	878.9	434800	621200
94-98	3-11/16 - 3-7/8	557.0	1228.0	490000	700000
100-102	3-15/16 - 4	612.0	1349.0	522100	746000
105-111	4-1/8 - 4-3/8	797.0	1757.0	607000	867200
114	4-1/2	871.0	1920.0	637300	910900